



Align Front-of-Class Units

A smart, all-in-one teaching solution that supports structured delivery and flexible classroom layouts. With generous storage, integrated display, and a clean, low-profile design, it fits seamlessly into modern learning environments. Ideal for new builds and refurbishments.

Features

- Lockable storage concealed behind sliding magnetic whiteboards
- Combines storage, display, and teaching tools in one unit
- Three adjustable shelves for flexible internal storage
- Choice of lower storage: tote tray bays or cupboards
- Works as a stand-alone unit or integrates with other modules

Options

- Lockable lower cupboards (keyed alike)
- Tote tray bays or cupboards at either end
- Available in three standard sizes:
 1. 2400w x 515d x 1900h (base unit: 730h)
 2. 3600w x 515d x 1900h (base unit: 730h)
 3. 3600w x 515d x 2070h (base unit: 900h)
- Size 3 offers the option to remove internal shelves on the left, allowing space for a digital screen behind the sliding door.
- Additional drawers and custom sizes available to suit your space. Speak to your local account manager for more information.



Assembly Required

For safety, we recommend securing the unit to a wall.

Finishes



Tote Trays

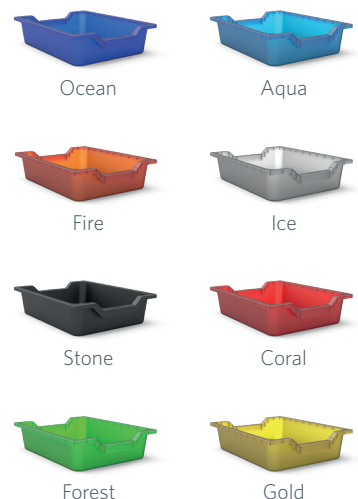

Align Front-of-Class Units

Standard



2400w x 1900h x 515d mm

Base unit: 730h

- 2 x Lockable sliding whiteboards
- 6 x Cupboards



2400w x 1900h x 515d mm

Base unit: 730h

- 2 x Lockable sliding whiteboards
- 4 x Cupboards
- 2 x 5 Tote tray bays



2400w x 1900h x 515d mm

Base unit: 730h

- 2 x Lockable sliding whiteboards
- 1 x Open shelf on right end
- 5 x 5 Tote tray bays



3600w x 1900h x 515d mm

Base unit: 730h

- 2 x Lockable sliding whiteboards
- 8 x Cupboards



3600w x 1900h x 515d mm

Base unit: 730h

- 2 x Lockable sliding whiteboards
- 8 x Cupboards
- 2 x 5 Tote tray bays (one each end)



3600w x 1900h x 515d mm

Base unit: 730h

- 2 x Lockable sliding whiteboards
- 2 x Cupboards (one each end)
- 8 x 5 Tote tray bays

Tall



3600w x 2070h x 515d mm

Base unit: 900h

- 2 x Lockable sliding whiteboards
- 8 x Cupboards
- Space to mount screen behind whiteboards



3600w x 2070h x 515d mm

Base unit: 900h

- 2 x Lockable sliding whiteboards
- 8 x Cupboards



Note: Whiteboard doors may not be shown in all product images. All units include internal shelving behind the sliding whiteboards.

Option: Lockable base cupboards available on request.

Align Front-of-Class Units



Check that you have received **eight** packages.

*2400mm Tote Base Unit will be delivered in seven packages.

Please note: If you have ordered multiple Front of Class Units, all eight packages for the same unit will be identified with the same letter, (e.g. Unit A). Wall fixing hardware not included.

Supplied Parts			Fasteners	
	Front of Class Unit Bases (A and B)	x2		Surefix screws 8*1-1/4 x20
	Front of Class Unit Tops (A and B)	x2		Titus Hilo Screws 32mm x36
	Front of Class Unit Sides	x2		Hingefast Screw 5*5/8 x40
	Whiteboard Doors	x2		Cover Caps x36
	Top Aluminium Track	x1	*Quantity may vary depending on the size of your unit.	
	Bottom Aluminium Tracks	x2		
4 x "L" Brackets (screwed into bottom track)		x2	You will need:	
		Impact Driver	<input type="checkbox"/>	#2 SQZ Driver Bit
			<input checked="" type="checkbox"/>	#2 Pozi Driver Bit
			<input type="checkbox"/>	#1 Square Driver Bit

Assembly Instructions

Step 1

Position Base Units A and B in their final location. Join them using Titus Hilo screws in the pre-drilled holes. *Skip this step for 2400mm Tote Base Units.

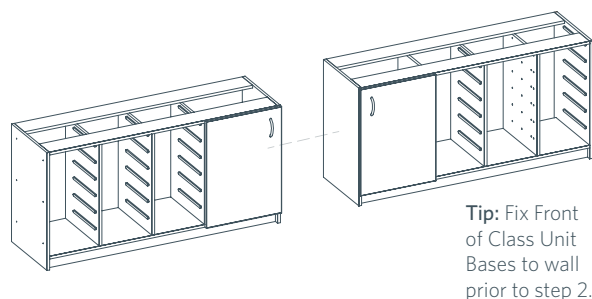

Step 2

Place Tops A and B onto the Unit Base, aligning the sides and back. Secure in place by screwing through the top of the Base using Surefix screws and the pre-drilled holes.

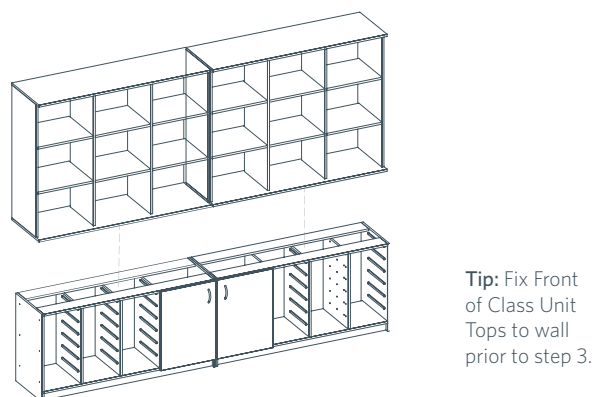

Step 3

Using the pre-drilled holes (marked in red), screw the aluminium track into place with Hingefast screws. Slide the whiteboard doors onto the tracks, making sure the lockable door is at the front. Then, attach the "L Brackets" to each end of the bottom aluminium track using the same screws.

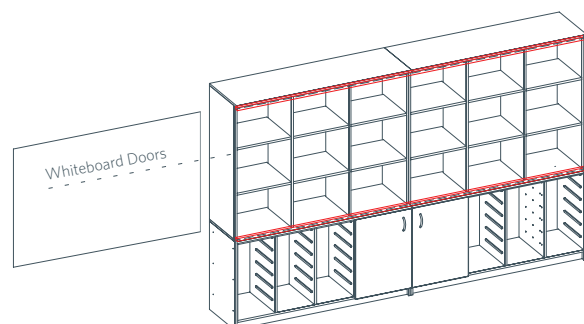

Step 4

With the whiteboard doors in place, attach both Unit Sides using 24 Titus Hilo screws in the pre-drilled holes. Finish by covering the screw heads with the provided cover caps.

